

| Product  | Manufacturer     | Power                      |
|--|------------------|----------------------------|
| 1 Charbroiler 36x27  |                  |                            |
| 2 Double Free Standing Heat Lamp with Pan and Grate            | Avantco          | 120V; 500W                 |
| 3 Panini Sandwich Press with Smooth Aluminum Plates            | Vollrath         | 120V; 1800W                |
| 4 Electric Hot Dog Steamer                                     | Crown Verity     | 240V                       |
| 5 24" x 60" Work Table with 4" Backsplash/Undershelf           | Regency          |                            |
| 6 Refrigerated Glass Door Merchandiser with LED Lighting       | Beverage-Air     | 115V; 8.8 Amps; 60 Hertz   |
| 7 24" x 42" Work Table with Galvanized Legs and Undershelf     | Regency          |                            |
| 8 24" x 96" Work Table with 4" Backsplash and Undershelf       | Regency          |                            |
| 9 Compact Undercounter Refrigerator with Glass Doors           | Beverage-Air     | 1/4 HP; 8.2 Amps; 60 Hertz |
| 10 Remote Ice Machine Condenser                                | Manitowoc        | 208-230V; 1 Phase          |
| 11 22" One Compartment Sink without Drainboard 17"x17"x12"     | Regency          |                            |
| 12 8' x 12' x 7'6" Indoor Walk-In Freezer with Aluminum Floor  | Kolpak           | 208V; 230W                 |
| 13 12' x 6' x 7' Indoor Walk-In Cooler Side Mounted Fridge     | Kolpak           | 115V                       |
| 14 18" x 72" Green Epoxy Shelf Kit with 74" Posts              | Regency          |                            |
| 15 Two Pan Steam Table with Legs and Undershelf                | APW Wyott        | 120V; 1000W                |
| 16 Bun Pan Rack for Reach-Ins                                  | Avantco          |                            |
| 17 Open Front Cabinet Base Work Table, Fixed Mid Shelf 24"x60" | Advance Tabco    |                            |
| 18 Open Front Cabinet Base Work Table, Fixed Mid Shelf 30"x72" | Advance Tabco    |                            |
| 19 Energy Efficient High Temp Undercounter Dishwasher          | Jackson DishStar | 208/230V; Phase 1          |

| Product  | Manufacturer              | Power                        |
|--|---------------------------|------------------------------|
| 20 72" Right Side Soil Dish Table with Scrap Block             | Eagle Group               |                              |
| 21 Double Stack Pizza Oven                                     | Cooking Performance Group | 115V                         |
| 22 (3) Solstice Liquid Propane 40-50lb. Floor Fryer            | Pitco                     | Liquid Propane               |
| 23 Hand Sink, Backsplash Mount Faucet and Lever Operated Drain | Advance Tabco             |                              |
| 24 Standing Mop Sink 21" x 24" x 8"                            | Regency                   |                              |
| 25 60" 2 Door Refrigerated Sandwich Prep Table                 | Avantco                   | 115V; 1/4 hp compressor      |
| 26 93" 3 Door Refrigerated Pizza Prep Table                    | Avantco                   | 115V; 1/4 hp compressor      |
| 27 3 Compartment Commercial Sink with Left Drainboard 77"Long  | Advance Tabco             |                              |
| 28 Air Cooled Medium Cube Ice Machine with Bin 525 lb.         | Scotsman                  | 115V, Phase 1                |
| 29 Double Deck Convection Oven                                 | Blodgett Zephaire         | 115V, Phase 1                |
| 30 6 Burner Range with Standard Oven                           | Cooking Performance Group | Field Converter, Natural Gas |
| 31 36" Gas Griddle with Manual Controls and Cabinet Base       | Cooking Performance Group | Field Converter, Natural Gas |
| 32 Receiving Line Table with Open Front Cabinet Base 36"x144"  |                           |                              |
| 33 2 Door Beverage Cooler 40"x28"                              |                           |                              |
| 34 Beverage Soda Dispenser with Ice Bin                        |                           |                              |
| 35 Work Table with Sink 60"x30"                                |                           |                              |
| 36 Work Table 24"x72"  |                           |                              |
| 37 A/C   |                           |                              |
| 38 Exhaust Custom Hood 24"x36" with Suppression System         |                           |                              |

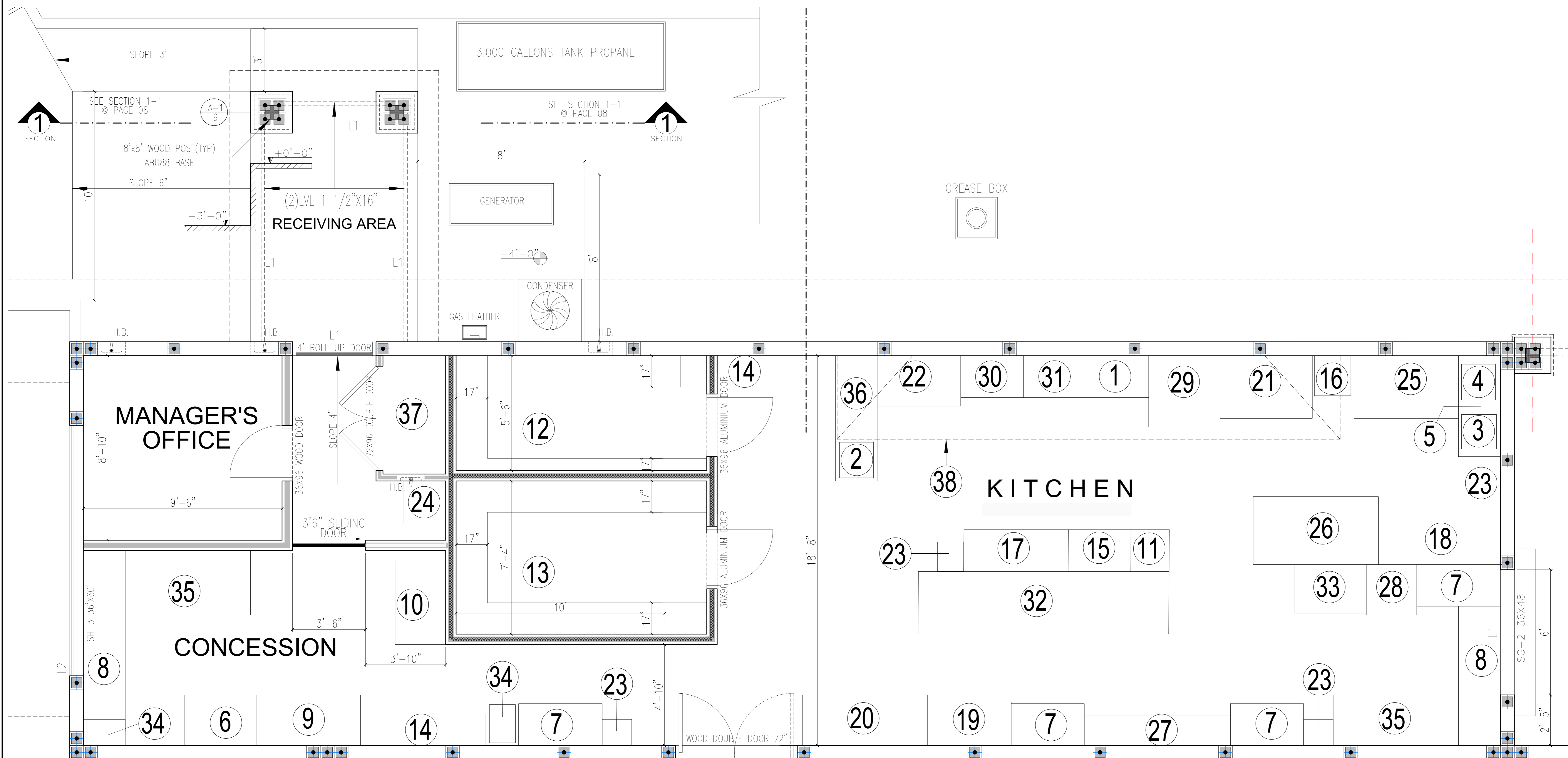

PAGE FORMAT: ISO A0 - EXTENTS

**BLACK PRONG**  
KITCHEN LAYOUT

|                  |                       |
|------------------|-----------------------|
| OWNER            | G. Bombonato          |
| DESIGNER/MANAGER | G. Moretoni           |
| ARCHITECT        | R.B. Mahoney          |
| ACAD INFO        |                       |
| REVISION DATE    | 2019/06/21            |
| PROJ. DATE       | 2019/04/26            |
| FILE VERSION     | V13 - BLACK PRONG.dwg |
| PAGE             | 07                    |

**KITCHEN FLOOR PLAN**

SCALE 1/4" = 1'-0"

Client: **BLACK PRONG EQUESTRIAN VILLAGE**  
 Address: **450 SE County Road 337**  
 Complements: **Bronson, FL 32621 PARCEL NUMBER 0368400100**

These plans and project specifications comply with the minimum applicable State of Florida Building Code, (2017 FBC 6th Edition; NEC 2014 electrical code) and local area building codes and ordinances with respect to current engineering practices.  
 Engineering/Architect \_\_\_\_\_ date: \_\_\_\_\_  
 Florida Registration number: \_\_\_\_\_

